

LMFC
LMKC

Centered Flange Type (Metric Dimension)



LMFC



LMKC

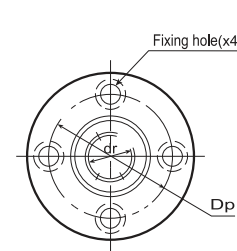

LMFC

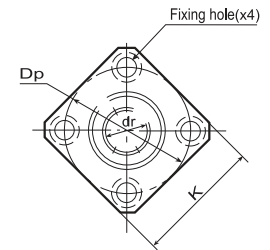
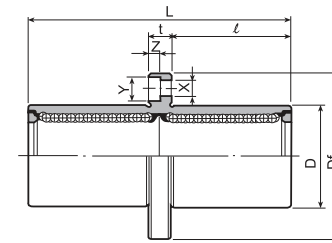

LMKC

Nominal shaft diameter mm	Model No.		Main dimensions and tolerance							
	LMFC...UU LMKC...UU	mm	dr		D		L		Flange	
			Tolerance μm	mm	Tolerance μm	mm	Tolerance mm	l mm	Df mm	
6	LMFC6UU	6	0	12	0	35	± 0.3	15	28	
	LMKC6UU									-13
8	LMFC8UU	8		15	-13	45		24.5	40	
	LMKC8UU									
10	LMFC10UU	10		19	0	55		25.5	42	
	LMKC10UU									
12	LMFC12UU	12		21	0	57		27.5	43	
	LMKC12UU									
13	LMFC13UU	13		23	-16	61		32	48	
	LMKC13UU									
16	LMFC16UU	16		28	0	70		36	54	
	LMKC16UU									
20	LMFC20UU	20	32	0	80	52	62			
	LMKC20UU									
25	LMFC25UU	25	40	-12	112	56.5	74			
	LMKC25UU									
30	LMFC30UU	30	45	-19	123	62.5	82			
	LMKC30UU									
35	LMFC35UU	35	52	0	135	69	96			
	LMKC35UU									
40	LMFC40UU	40	60	-22	151	89.5	116			
	LMKC40UU									
50	LMFC50UU	50	80	0	192	95.5	134			
	LMKC50UU									
60	LMFC60UU	60	90	-20	209	95.5	134			
	LMKC60UU									

Main dimensions and tolerance						Eccentricity μm	Squareness μm	Basic load rating		Weight g	Nominal shaft diameter mm
Flange								dynamic C(kgf)	static Co(kgf)		
K mm	t mm	Dp mm	X mm	Y mm	Z mm						
—	5	20	3.5	6	3.1	15	15	33	54	31 25	6
22	5	24	3.5	6	3.1			44	80	51 43	
—	6	29	4.5	7.5	4.1			60	112	98 78	10
25	6	32	4.5	7.5	4.1			83	160	110 90	
—	6	33	4.5	7.5	4.1			83	160	130 108	13
30	6	38	4.5	7.5	4.1			125	240	190 165	
—	8	43	5.5	9	5.1			143	280	260 225	20
32	8	51	5.5	9	5.1			159	320	540 500	
—	10	60	6.6	11	6.1			254	560	680 590	30
34	10	67	6.6	11	6.1			270	640	1,020 930	
—	13	78	9	14	8.1			350	820	1,570 1,380	40
37	13	98	9	14	8.1			620	1621	3,600 3,400	
—	18	112	11	17	11.1	770	2040	4,500 4,060	60		
42	18	112	11	17	11.1	770	2040	4,500 4,060		60	
—	—	—	—	—	—	—	—	—	—		—